

FLOORPLAN

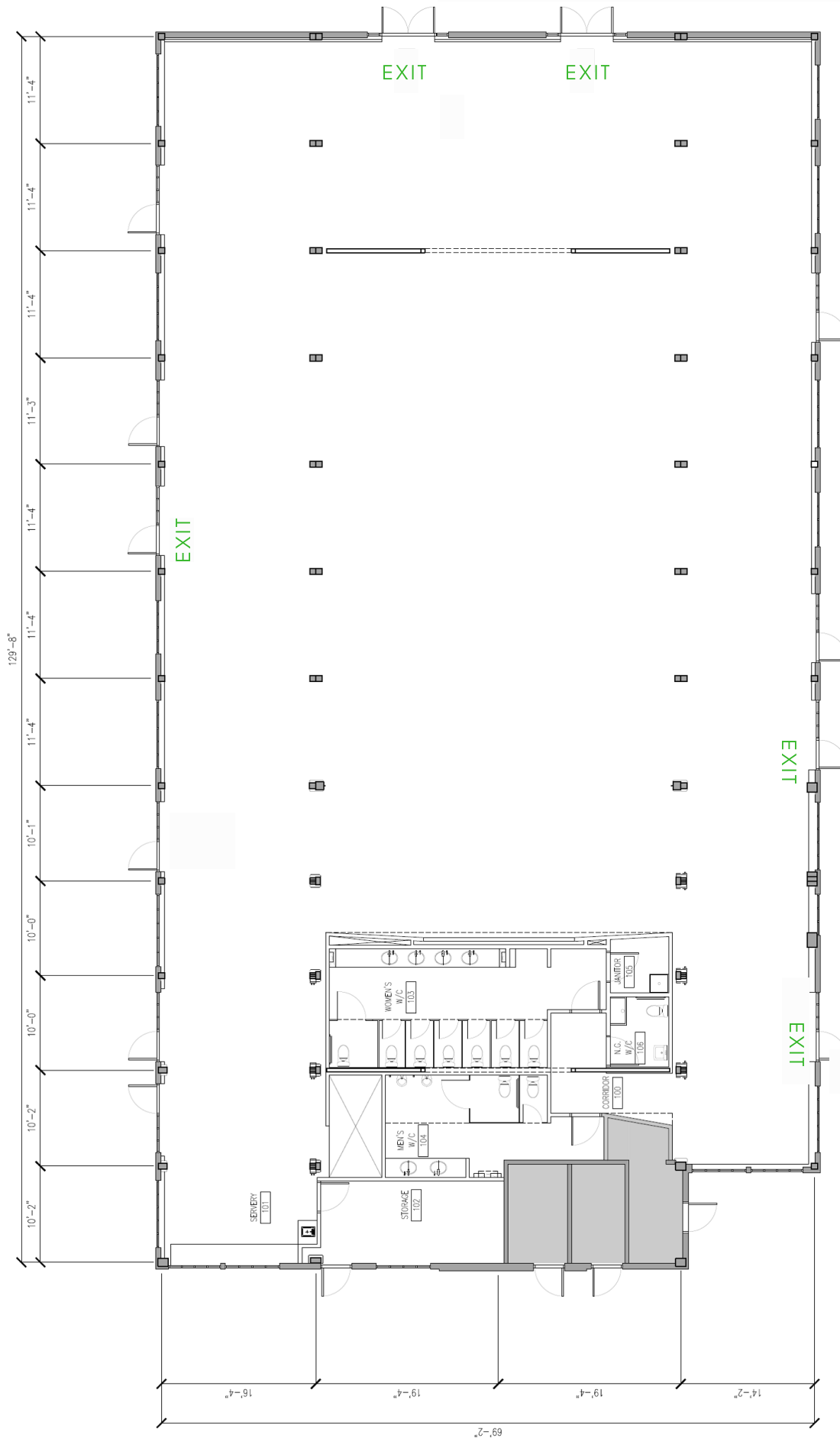

Additional measurements:
 Width of the entire venue (East to West) 69'-2"
 Length of entire venue (North to South) 129'-8"
 In between the pillars (East to West) 39'
 The backlit frame size is a 16x9 aspect ratio at 11' high by 19'-6 11/16" wide.
 The height, floor to beams 23 ft and floor to ceiling is 35 ft.